

2012



STATISTICAL YEARBOOK

From 7 Safar 1433 A.H.
To 18 Safar 1434 A.H.



DAMMAM
DI ARABIA
N ARAR

Tabuk

402

TAIF

74%

CARGO FLIGHTS

www.gaca.gov.sa

SUBJECT	Page
Overview	2
<ul style="list-style-type: none"> The Emergence of GACA Vision Mission Objectives 	
Features & Statistics	3
Airport Names & Codes in Kingdom of Saudi Arabia	4
Kingdom-wide Airport Traffic	5
Kingdom's International Airports	6-8
<ul style="list-style-type: none"> Number of Flights at Kingdom's International Airports Passengers Movement at Kingdom's International Airports Cargo at Kingdom's International Airports 	
Kingdom's Domestic Airports	9-11
<ul style="list-style-type: none"> Total Traffic For Domestic Airports Domestic Traffic at Domestic Airports International & General Aviation Traffic at Domestic Airports 	
Passenger Market Shares	12
<ul style="list-style-type: none"> International Airports Shares Domestic Airports Shares 	
National Carriers Shares	13
<ul style="list-style-type: none"> National & Foreign Carriers Shares National Carriers Shares for Domestic Passengers and International Passengers 	
General Information	14-15
<ul style="list-style-type: none"> Seasonal Passengers Traffic at Kingdom's Airports Airline Fleets in Middle East 	



الهيئة العامة للطيران المدني
General Authority of Civil Aviation

Overview

The Emergence of GACA:

The beginning of Civil Aviation in the Kingdom goes back to the year 1364 AH, when the Kingdom gained its first civil aircraft during the reign of King Abdulaziz. The Kingdom's first civil aviation system was established in 1372AH. The Civil Aviation comprised of Saudi Arabian Airlines and Meteorology Department when it was separated from the Saudi Royal Air Force. The Saudi Arabian Airlines was detached from the Civil Aviation in 1379AH and was followed by Meteorological Department separating in 1386 AH. thus leaving it independent with its own budget. In 1397AH, The Department of Civil Aviation was renamed as the Presidency of Civil Aviation. In 1425AH, The Council of Ministers decided and issued a ruling to transform the Presidency of Civil Aviation to an autonomous entity and named General Authority of Civil Aviation (GACA).

In 1432AH, it has been separated from Ministry of Defense through Royal Decree with redrawn basic organizational structure to let it enjoy a legal and public status with its own administrative and financial independence. The direct supervision of the Premier would give it more motivation and greater independence for smooth and harmonious progress and development of air transport industry.

VISION:

Developing constantly the secured airspace according to the highest standards of safety and extending the excellent services to customers at our airports.

MISSION:

Development of Air Transport through: Construction and Management; Provision & Operation of Vital Systems and Infrastructure for Airports and Air Navigation with Essential Maintenance of the highest standards and modern systems; Application of Rules, Regulations and Procedures to ensure the Safety and Security of Air Transport.



The design for the new King Abdulaziz International Airport

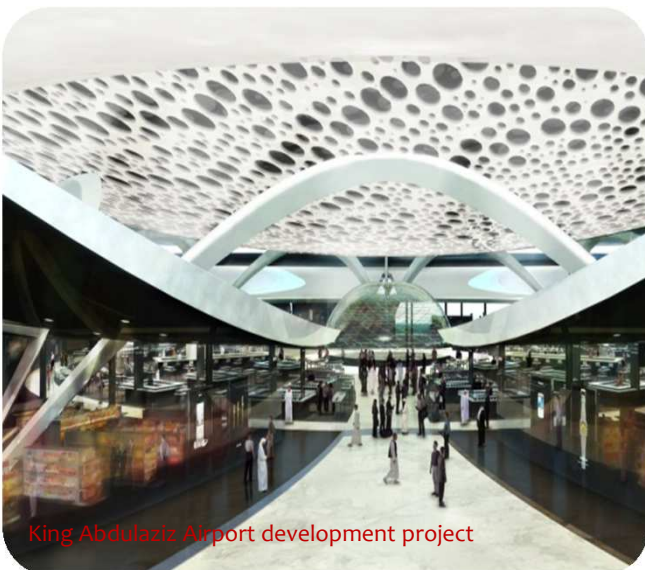

King Abdulaziz Airport development project

OBJECTIVES:

- Develop the Financial Resources for GACA and accomplish the Financial Autonomy by following the Commercial Fundamentals.
- Encourage Investment Opportunities in Air Transport Sector.
- Provide the Excellent Services to Pilgrims and Passengers as per Contemporary Global Standards.
- Construction, Management and Upgrading of Basic Infrastructure for Air Transport Sector according to latest & modern systems.
- Introduce and Develop Procedures to ensure the Safety and Security of Air Transport.
- Establish criteria for Operation and Maintenance for Air Transport according to the Global Standards.
- Achieve the ideal performance of Human Resources and Employees Contentment in Excellent Work Environment.
- The strengthening of regional and international cooperation and effective participation in decision-making processes in the air transport industry.
- Protection of the environment and the negative impacts of air transport.
- Organization and development of air transport in accordance with the best international applications
- Create and convert strategic business units and activities into independent viable business entities.



Preview of Air Traffic at the Kingdom's Airports during 2012:

Following are some significant features of air traffic at Kingdom's airports during the year 2012:

- The number of passengers at Saudi Arabian airports reached more than 64 million passengers, an increase of 19 % over 2011.
- The aircraft operations at Kingdom's Airports have increased by 17 % over 2011 and reached 558791 operations and that was due to:
 - ✓ The Introduction of new carriers at Kingdom's airports.
 - ✓ Rising numbers of Pilgrims and visitors to the Holy Mosques.
 - ✓ Launching of International flights from some Domestic Airports.
- The volume of Cargo and Mail was 1018328 tons in 2012 and is 34 % more than the volume in 2011 .





Airport Names & Cities in Kingdom of Saudi Arabia

الهيئة العامة للطيران المدني
General Authority of Civil Aviation

Qassim Airport new design

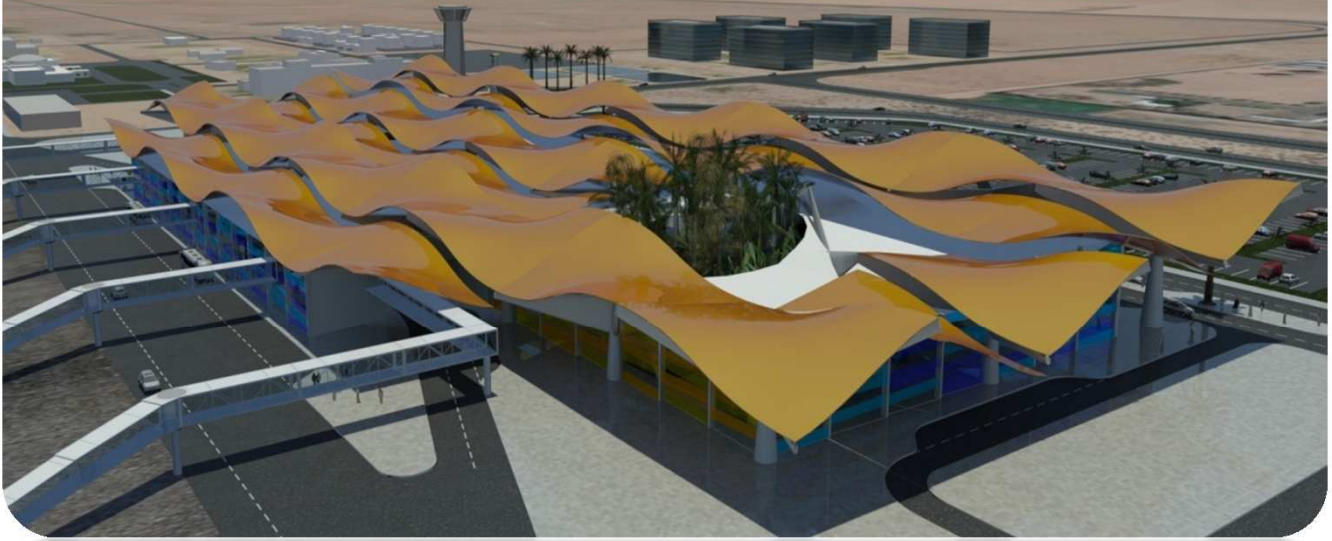

Airport Name *	CODE
JEDDAH, King Abdulaziz International Airport	JED
RIYADH, King Khaled International Airport	RUH
DAMMAM, King Fahd International Airport	DMM
MADINAH, Prince Mohammad Bin Abdulaziz International Airport	MED
ABHA Airport	AHB
JAZAN, King Abdullah Bin Abdulaziz Airport	GIZ
TABUK, Prince Sultan Bin Abdulaziz Airport	TUU
AL-GASSIM Airport	ELQ
TAIF Airport	TIF
NAJRAN Airport	EAM
YANBU, Prince Abdulmohsin Bin Abdulaziz Airport	YNB
HAIL Airport	HAS
AL-JOUF Airport	AJF
BISHA Airport	BHH
AL-BAHA Airport	ABT
ARAR Airport	RAE
AL-AHSA Airport	HOF
GURAYAT Airport	URY
SHARURAH Airport	SHW
AL-QAISUMAH, Hafr Albatin Airport	AQI
WADI AL-DWASER	WAE
WEDJH Airport	EJH
TURAIIF Airport	TUI
RAFHA Airport	RAH
DAWADMI, Prince Salman Bin Abdulaziz Airport	DWD
HAFR AL-BATIN, King Khaled Military City Airport	KMC
RABIGH Airport	RGB
Al-Ula, Prince Abdulmajeed Bin Abdulaziz Airport	ULH

* The list of the airports has been sorted by Passenger Traffic volume.



Kingdom-wide Airport Traffic

Airports	Flights		Passengers (thousands)		Freight & Mail (tons)	
	2011	2012	2011	2012	2011	2012
International Airports	395,723	466,494	46,866	55,339	743,565	1,003,562
Domestic Airports	84,028	92,297	7,594	9,433	14,904	14,766
Totals	479,751	558,791	54,460	64,773	758,469	1,018,328

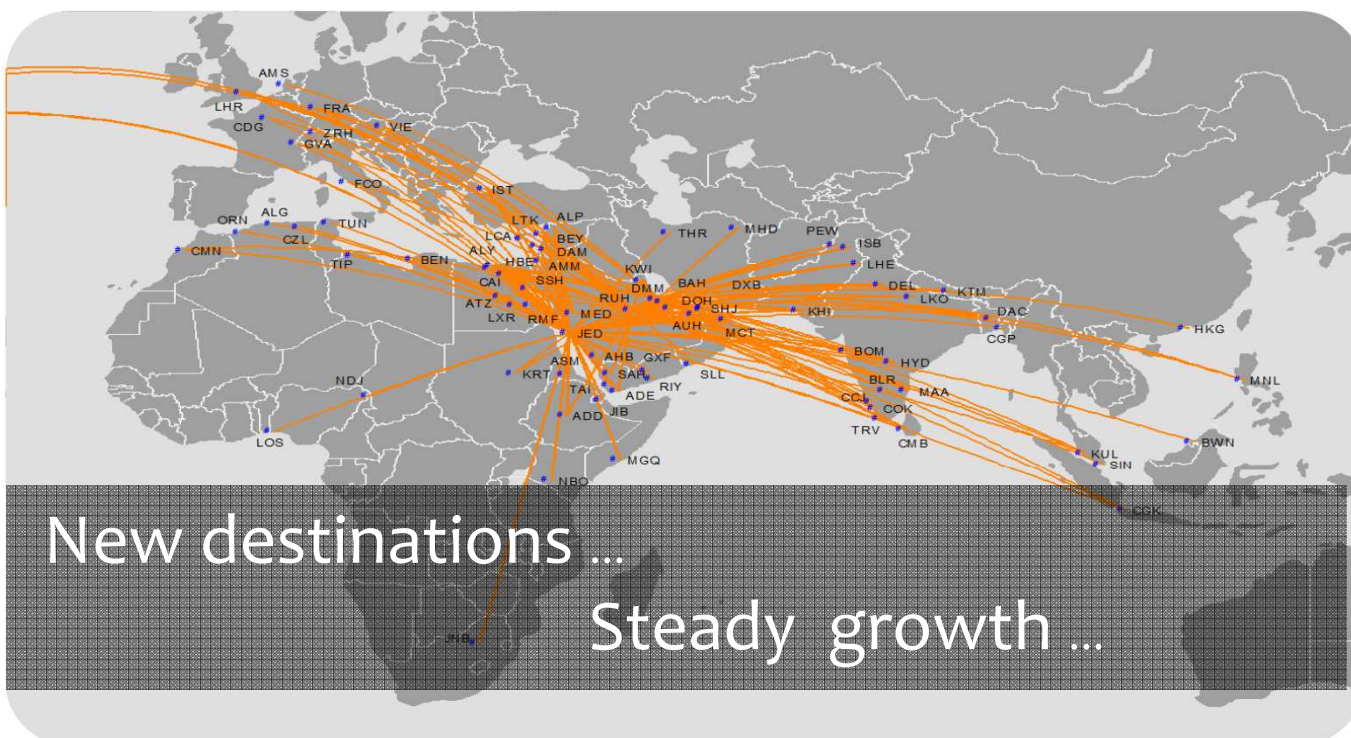
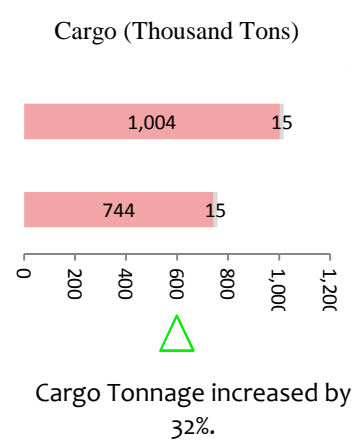
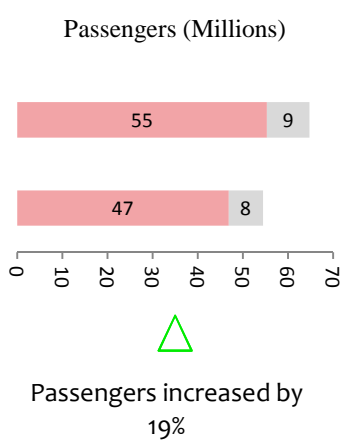
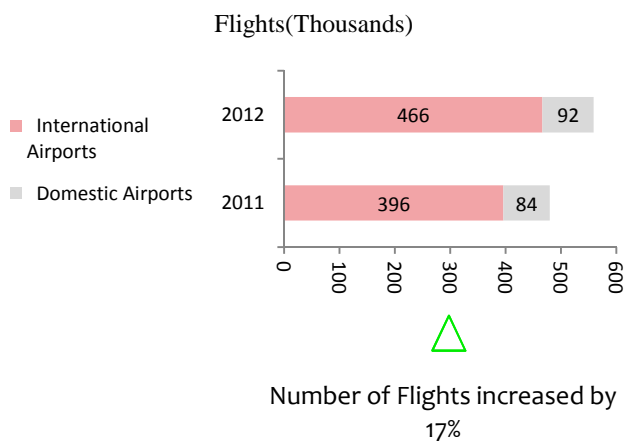

Number of Flights at Kingdom's International Airports

International Airports	F L I G H T S							
	International		Domestic		General Aviation		Totals	
	2011	2012	2011	2012	2011	2012	2011	2012
King Abdulaziz International	95,971	129,165	51,929	64,536	14,938	14,508	162,838	208,209
King Khaled International	58,163	65,224	60,668	71,167	19,679	17,142	138,510	153,533
King Fahd International	29,003	32,146	21,933	23,679	11,124	11,565	62,060	67,390
Prince Muhammad Bin Abdulaziz International	13,654	18,402	17,977	18,900	684	60	32,315	37,362
Totals	196,791	244,937	152,507	178,282	46,425	43,275	395,723	466,494

** Flight data has been changed in the King Khaled International Airport in 2012&2011.

Number of Flights at Kingdom's International Airports
(in thousands)

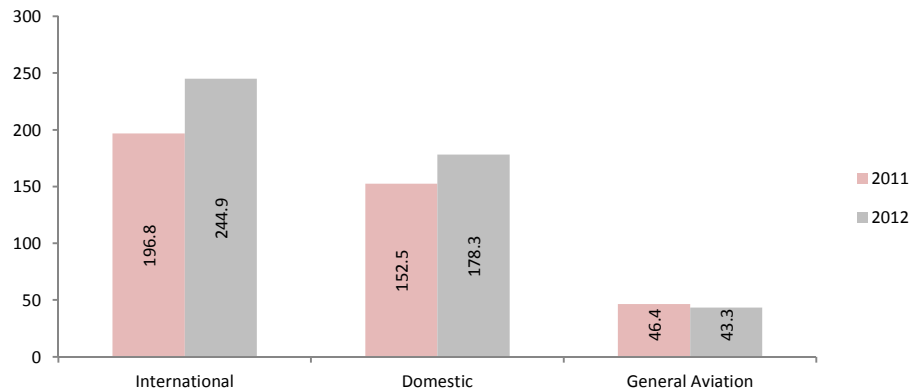

- △ International Flights increased by 25%
- △ Domestic Flights increased by 16.9%
- ▽ General Aviation Flights decreased by 6.8%

- △ Flights increased at King Abdulaziz International Airport by 28%
- △ Flight increased at King Khaled International Airport by 10.8%
- △ Flights increased at King Fahd International Airport by 8.6%
- △ Flights increased at Prince Mohammad Bin Abdulaziz International Airport by 15.6%

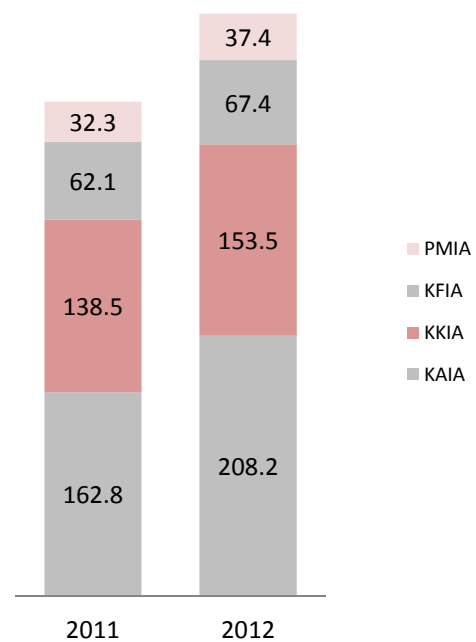

Passengers Movement at Kingdom's International Airports

International Airports	Passengers (in thousands)									
	International*		Domestic		General Aviation		Transit**		Totals	
	2011	2012	2011	2012	2011	2012	2011	2012	2011	2012
King Abdulaziz International Airport	16,003	18,890	6,814	8,142	81	79	33	91	22,898	27,111
King Khaled International Airport	7,408	8,288	7,428	8,721	52	60	597	682	14,889	17,069
King Fahd International Airport	2,932	3,454	2,335	2,682	265	286	339	266	5,531	6,422
Prince Mohammad Bin Abdulaziz International Airport	2,131	3,127	1,414	1,611	5	1	107	59	3,549	4,738
Totals	28,474	33,758	17,991	21,155	402	426	1,076	1,098	46,866	55,339

* International traffic includes Hajj and Umrah passengers on chartered flights.

** Transit Passengers are not included in Totals.

Passengers Movement at Kingdom's International Airports
(in million)

△ International Passengers increased by 18.6%

△ Domestic Passengers increased by 17.6%

△ General Aviation Passengers increased by 5.9%

△ Transit Passengers increased by 2.1%

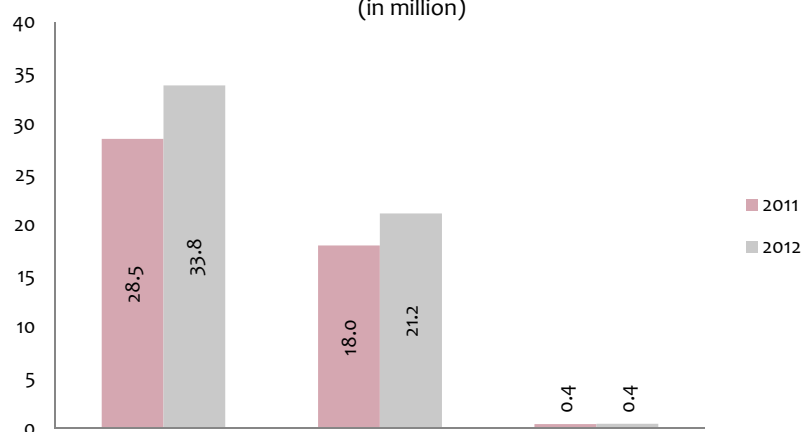

△ Passengers at King Abdulaziz International Airport increased by 18.4%

△ Passengers at King Khaled International Airport increased by 14.6%

△ Passengers at King Fahd International Airport increased by 16.1%

△ Passengers at Prince Mohammad Bin Abdulaziz International Airport increased by 33.5%

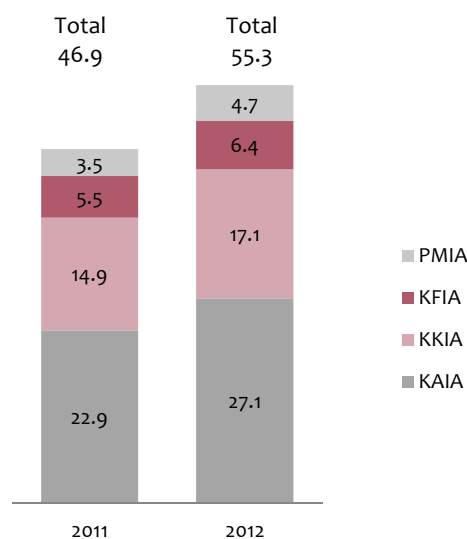

Cargo at Kingdom's International Airports

International Airports	Cargo in tons							
	International		Domestic		Gen. Aviation		Totals	
	2011	2012	2011	2012	2011	2012	2011	2012
King Abdulaziz International	226,438	348,601	39,191	58,484	0	0	265,629	407,085
King Khaled International	338,873	437,380	42,858	40,193	9,184	9,233	390,915	486,806
King Fahd International	72,025	92,739	10,231	10,087	576	594	82,832	103,421
Prince Muhammad Bin Abdulaziz International	2,016	3,801	2,173	2,449	0	0	4,189	6,251
Totals	639,352	882,521	94,453	111,214	9,760	9,827	743,565	1,003,562

* Data has been changed in King Khaled International Airport in 2012&2011.

Cargo (loaded & unloaded) at Kingdom's International Airports for 2012& 2011

- △ International Cargo increased by 38%
- △ Domestic Cargo increased by 17.7%
- △ General Aviation Cargo increased by 0.7%

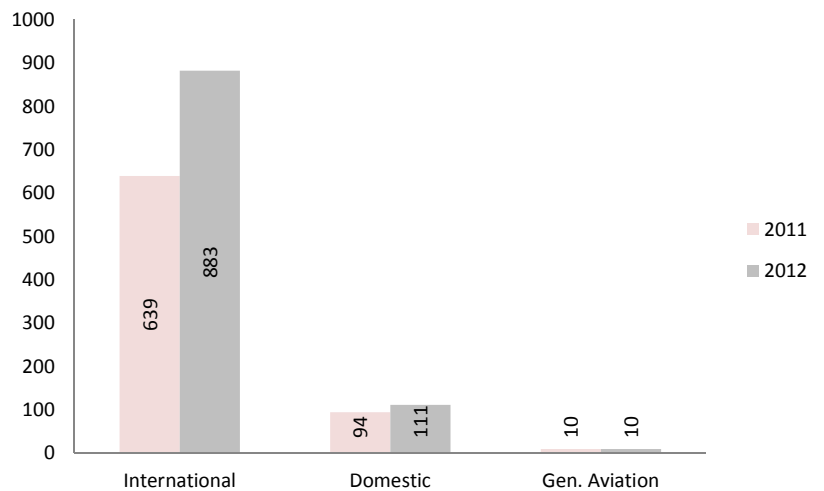

- △ Cargo at KAIA increased by 53.3%
- △ Cargo at KKIA increased by 25%
- △ Cargo at KFIA increased by 24.9%
- △ Cargo increased by 49.2% at PMIA

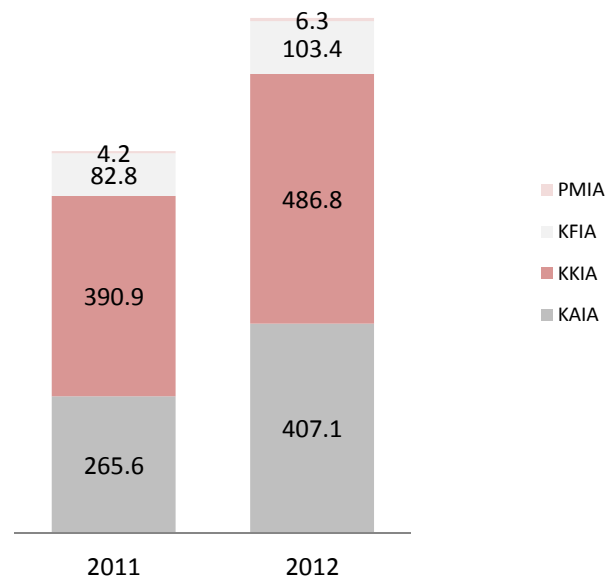

Total Traffic at Domestic Airports

Domestic Airport	Total Traffic								
	Flights			Passengers (in thousands)			Cargo (in tons)		
	2011	2012	Change %	2011	2012	Change %	2011	2012	Change %
1 Abha	15,860	18,204	14.8%	1,809	2,124	17.4%	3,671.4	4,239.8	15.5%
2 Tabuk, Prince Sultan Airport	8,061	8,104	0.5%	797	981	23.1%	2,062.9	2,156.1	4.5%
3 Taif	5,393	5,905	9.5%	530	684	28.9%	498.4	494.0	-0.9%
4 Al-Gassim, Prince Naif Airport	5,948	7,374	24.0%	595	772	29.7%	1,140.5	1,055.1	-7.5%
5 Hail	3,962	4,358	10.0%	333	488	46.5%	1,276.4	1,175.0	-7.9%
6 Gazan, King Abdullah Airport	8,128	8,729	7.4%	920	1,164	26.4%	3,258.9	2,605.8	-20.0%
7 Al-Baha	2,543	2,990	17.6%	268	329	22.7%	87.5	113.2	29.3%
8 Wadi Dawaser	1,110	1,629	46.8%	69	96	40.2%	12.6	8.3	-33.9%
9 Sharurah	1,856	1,544	-16.8%	95	102	6.9%	54.6	74.3	36.1%
10 Turaif	1,244	946	-24.0%	51	51	1.4%	32.4	20.4	-37.0%
11 Bisha	2,987	3,332	11.6%	275	338	22.9%	77.4	120.3	55.5%
12 Ar'ar	2,249	2,009	-10.7%	181	193	6.4%	440.4	389.2	-11.6%
13 Wedjh	1,011	852	-15.7%	52	47	-10.1%	18.7	17.4	-6.7%
14 Rafha	1,008	737	-26.9%	37	44	16.9%	27.8	35.1	26.1%
15 Nejran	5,656	5,678	0.4%	481	549	14.1%	662.5	605.5	-8.6%
16 Al-Qaisumah	1,291	1,874	45.2%	75	112	49.1%	86.4	100.2	16.0%
17 Al-Jouf	3,711	3,839	3.4%	309	327	5.7%	623.0	626.5	0.6%
18 Al-Ahsa	5,126	4,966	-3.1%	177	203	14.7%	185.0	241.7	30.7%
19 Al-Gurayat	1,640	1,681	2.5%	146	166	13.5%	340.2	319.8	-6.0%
20 Yanbu, Prince Abdulmohsin Airport	4,837	6,869	42.0%	377	636	68.8%	343.4	357.4	4.1%
21 Hafr Albatin (KKMC)	4	0	-100.0%	0	0	0.0%	0.0	0.0	0.0%
22 Al-Ula, Prince Abdulmajeed Airport	0	216	-	0	9	6914.5%	0.0	5.4	-
23 Dawadami, Prince Salman Airport	389	431	10.8%	15	19	31.0%	2.7	4.6	70.2%
24 Rabigh	18	30	66.7%	0	0	-7.1%	0.5	0.8	63.0%
Totals	84032	92,297	9.8%	7,594	9,433	24.2%	14,903.7	14,766.0	-0.9%

Flights (Thousands)



Flights increased by 9.8%

Passengers (Millions)

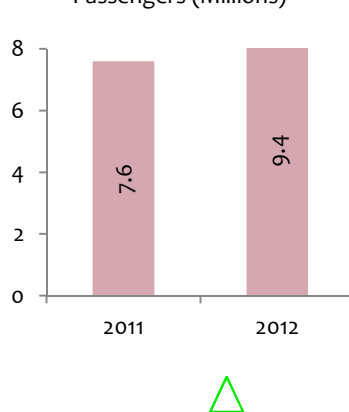

Passengers increased by 24.2%

Cargo (Thousand Tons)



Cargo decreased by 0.9%

Domestic Traffic at Domestic Airports

	Domestic Airport	Domestic Traffic								
		Flights			Passengers			Cargo (in tons)		
		2011	2012	Change %	2011	2012	Change %	2011	2012	Change %
1	Abha	14,412	16,285	13.0%	1,692,049	1,950,503	15.3%	3,632.9	4,210.3	15.9%
2	Tabuk, Prince Sultan Airport	7,548	7,397	-2.0%	756,896	905,723	19.7%	2,062.6	2,155.9	4.5%
3	Taif	4,554	3,724	-18.2%	431,683	439,906	1.9%	498.4	493.7	-0.9%
4	Al-Gassim, Prince Naif Airport	4,137	4,901	18.5%	396,513	473,746	19.5%	1,140.3	1,055.0	-7.5%
5	Hail	3,946	4,146	5.1%	332,835	467,554	40.5%	1,276.4	1,175.0	-7.9%
6	Gazan, King Abdullah Airport	8,069	8,621	6.8%	917,899	1,161,737	26.6%	3,258.9	2,604.3	-20.1%
7	Al-Baha	2,539	2,982	17.4%	268,334	329,430	22.8%	87.5	113.2	29.3%
8	Wadi Dawaser	1,108	1,623	46.5%	68,556	96,204	40.3%	12.6	8.3	-34.0%
9	Sharurah	1,804	1,460	-19.1%	94,416	100,758	6.7%	54.6	74.3	36.1%
10	Turaif	1,088	732	-32.7%	46,084	39,751	-13.7%	31.4	12.0	-61.7%
11	Bisha	2,983	3,324	11.4%	274,754	337,879	23.0%	77.4	120.3	55.5%
12	Ar'ar	2,185	2,001	-8.4%	180,328	192,807	6.9%	439.8	388.1	-11.7%
13	Wedjh	985	642	-34.8%	51,268	35,269	-31.2%	18.5	15.5	-16.3%
14	Rafha	1,006	723	-28.1%	37,145	43,344	16.7%	27.8	35.1	26.1%
15	Nejran	5,640	5,648	0.1%	481,404	548,816	14.0%	662.5	605.1	-8.7%
16	Al-Qaisumah	1,271	1,864	46.7%	74,480	111,861	50.2%	86.4	100.1	15.8%
17	Al-Jouf	3,472	3,543	2.0%	302,899	312,272	3.1%	622.1	622.2	0.0%
18	Al-Ahsa	238	234	-1.7%	25,333	27,096	7.0%	7.1	2.5	-65.3%
19	Al-Gurayat	1,638	1,667	1.8%	146,207	165,823	13.4%	340.2	319.8	-6.0%
20	Yanbu, Prince Abdulmohsin Airport	2,927	3,028	3.5%	209,316	238,058	13.7%	211.8	225.4	6.4%
21	Hafr Albatin (KKMC)	4	0	-100.0%	0	0	0.0%	0.0	0.0	0.0%
22	Al-Ula, Prince Abdulmajeed Airport	0	214	-	0	8,682	-	0.0	5.4	-
23	Dawadami, Prince Salman Airport	387	431	11.4%	14,711	19,293	31.1%	2.7	4.6	69.4%
Totals		71,937	75,190	4.5%	6,803,110	8,006,512	17.7%	14,551.8	14,346.1	-1.4%

Flights (thousands)

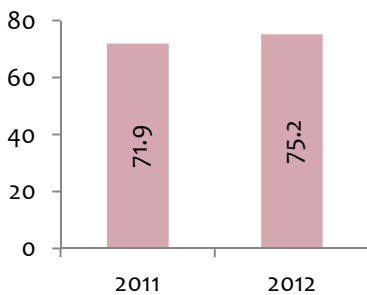

Flights increased by 4.5%

Passengers (Million)

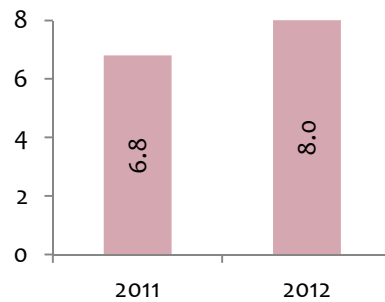

Passengers increased by 17.7%

Cargo (thousand tons)

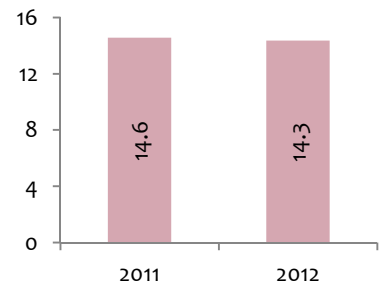

Cargo decreased by 1.4%

International & General Aviation Traffic at Domestic Airports

International Traffic at Domestic Airports

Domestic Airports	Flights			Passengers			Cargo (Tons)		
	2011	2012	Change %	2011	2012	Change %	2011	2012	Change %
1 Abha	1,312	1,735	32.2%	110,531	165,362	49.6%	38.4	29	-23.2%
2 Tabuk, Prince Sultan	289	625	116.3%	34,227	71,674	109.4%	0.0	0	-
3 Taif	779	2,087	167.9%	96,491	240,694	149.4%	0.0	0	-
4 Gazan, King Abdullah	1	2	100.0%	0	158	-	0.0	1	-
5 Hail	0	186	-	0	20,045	-	0.0	0	-
6 Ar'ar	2	2	0.0%	0	69	-	0.0	1	-
7 Wedjh	0	0	-	0	0	-	0.0	0	-
8 Turaif	0	0	-	0	0	-	0.0	0	-
9 Al-Baha	0	0	-	0	0	-	0.0	0	-
10 Al-Gassim, Prince Naif	1,751	2,387	36.3%	195,907	293,541	49.8%	0.0	0	-
11 Yanbu, Prince Abdulmohsin	1,260	2,923	132.0%	125,768	353,329	180.9%	0.0	0	-
Totals	5,394	9,947	84.4%	562,924	1,144,872	103.4%	38.4	32	-16.8%

General Aviation Traffic at Domestic Airports

Domestic Airport	Flights			Passengers			Cargo (Tons)		
	2011	2012	Change %	2011	2012	Change %	2011	2012	Change %
1 Abha	136	184	35.3%	6,290	8,403	33.6%	0.2	0.0	-100.0%
2 Tabuk, Prince Sultan	224	82	-63.4%	5,694	3,296	-42.1%	0.3	0.1	-62.5%
3 Taif	60	94	56.7%	2,170	3,248	49.7%	0.0	0.2	-
4 Al-Gassim, Prince Naif	60	86	43.3%	2,750	4,591	66.9%	0.2	0.0	-100.0%
5 Hail	16	26	62.5%	192	236	22.9%	0.0	0.0	-
6 Gazan, King Abdullah	58	106	82.8%	2,392	1,732	-27.6%	0.0	0.3	-
7 Al-Baha	4	8	100.0%	144	32	-77.8%	0.0	0.0	-
8 Wadi Dawaser	2	6	200.0%	50	7	-86.0%	0.0	0.0	-
9 Sharurah	52	84	61.5%	608	789	29.8%	0.0	0.0	-
10 Turaif	156	214	37.2%	4,424	11,481	159.5%	1.1	8.4	688.2%
11 Bisha	4	8	100.0%	141	10	-92.9%	0.0	0.0	-
12 Ar'ar	62	6	-90.3%	956	97	-89.9%	0.7	0.0	-100.0%
13 Wedjh	26	210	707.7%	566	11,319	1899.8%	0.2	2.0	977.3%
14 Rafha	2	14	600.0%	80	166	107.5%	0.0	0.0	-
15 Nejran	16	30	87.5%	81	563	595.1%	0.0	0.4	-
16 Al-Qaisumah	20	10	-50.0%	587	70	-88.1%	0.0	0.1	-
17 Al-Jouf	239	296	23.8%	6,413	14,521	126.4%	0.8	4.3	414.3%
18 Al-Ahsa	4,888	4,732	-3.2%	152,013	176,266	16.0%	177.9	239.3	34.5%
19 Al-Gurayat	2	14	600.0%	15	134	793.3%	0.0	0.0	-
20 Yanbu, Prince Abdulmohsin	650	918	41.2%	41,908	44,903	7.1%	131.6	132.0	0.3%
21 Al-Ula, Prince Abdulmajeed	0	2	#DIV/0!	124	16	-87.1%	0.0	0.0	-
22 Dawadami, Prince Salman	2	0	-100.0%	17	0	-100.0%	0.0	0.0	-
23 Rabigh	18	30	66.7%	70	65	-7.1%	0.5	0.8	63.0%
Totals	6,697	7,160	6.9%	227,685	281,945	23.8%	313.5	387.9	23.7%

Market Share for International & Domestic Airports

- The overall number of Passengers at King Abdulaziz International Airport, Jeddah increased by 18%. The growth is due to an increase of 18 % in International Passengers, and 20% in domestic passengers.
- A growth of 15% is noted in Passengers movement at King Khaled International Airport Riyadh, which is due to 12% increase in International and 17% increase in Domestic Passengers.
- The Passengers movement at King Fahd International Airport, Dammam is 16% more than the previous year. The International Passengers grew by 18% while Domestic Passengers by 15%
- Prince Mohammad Bin Abdulaziz International Airport registered an increase of 34% in Passengers movement. The number of International Passengers grew by 47 %, and Domestic Passengers by 14% .

International Airports Shares of Passengers Traffic

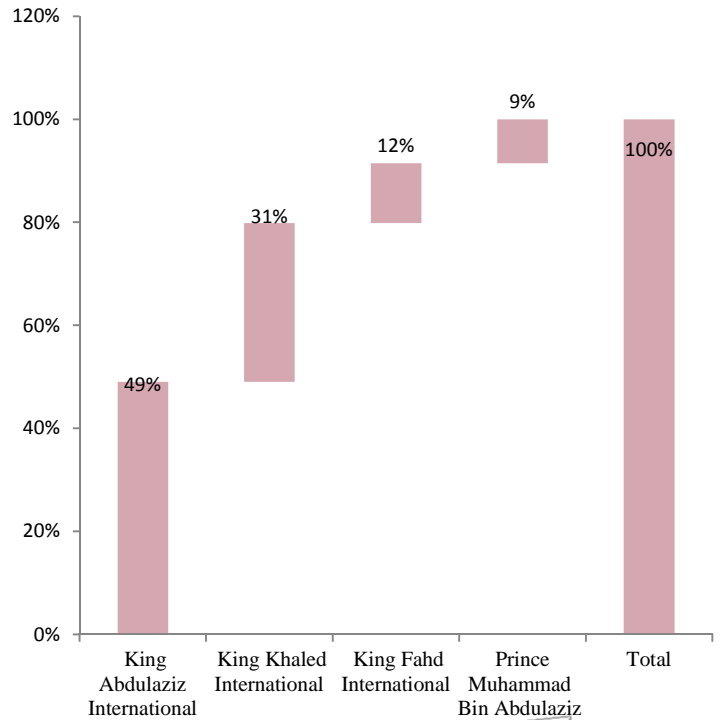

Domestic Airports Shares of Passengers Traffic

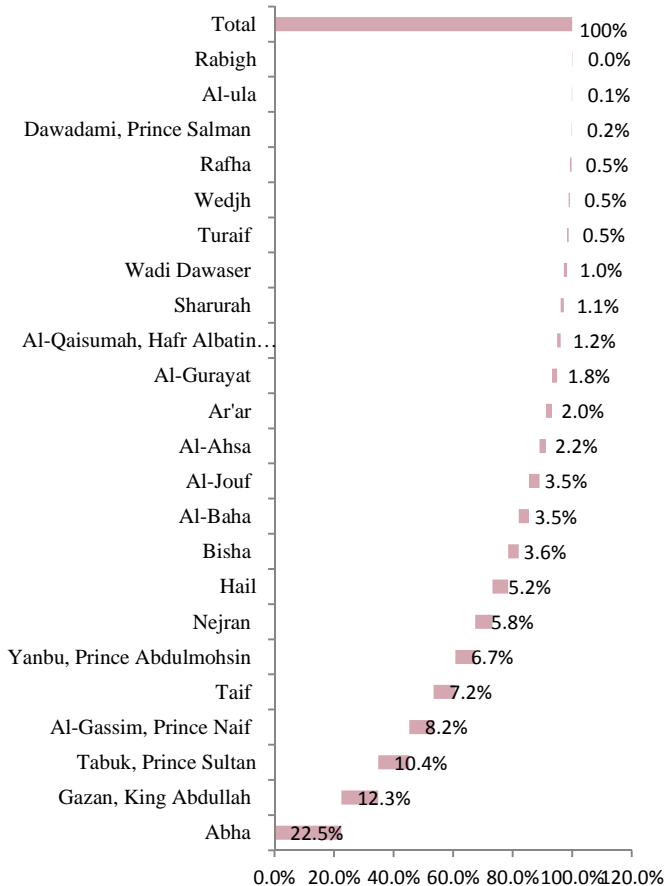

International traffic at six of domestic airports namely Abha, Taif, al-Gassim, Tabuk, Yanbu and Hail collectively have up-surged almost three fold from 216 to 563 thousands passengers in 2011. Egypt, United Arab Emirates and Yemen are among main destinations. The total passengers traffic at domestic airports has increased substantially by 24% over last year.

Airport Traffic Ranking for Middle East & Egypt for 2012

Middle East & Egypt: Top 10 Airports by Passengers

Rank	City, Country	Airport Code	Passengers (in millions)	% Change
1	Dubai, United Arab Emirates	DXB	57.68	13.2%
2	Jeddah, Saudi Arabia *	JED	27.20	18.6%
3	Doha, Qatar	DOH	21.29	17.0%
4	Riyadh, Saudi Arabia *	RUH	17.75	14.6%
5	Cairo, Egypt	CAI	14.84	14.0%
6	Abu Dhabi, United Arab Emirates	AUH	14.70	18.9%
7	Tehran, Iran	THR	13.98	5.6%
8	Kuwait	KWI	8.97	5.0%
9	Bahrain	BAH	8.48	8.8%
10	Muscat	MCT	7.55	16.5%

Middle East & Egypt: Top 10 Airports by Cargo

Rank	City, Country	Airport Code	Cargo (tons)	% Change
1	Dubai, United Arab Emirates	DXB	2 279 624	3.9%
2	Doha, Qatar	DOH	844 532	4.5%
3	Abu Dhabi, United Arab Emirates	AUH	574 012	17.6%
4	Jeddah, Saudi Arabia *	JED	407 085	53.3%
5	Riyadh, Saudi Arabia *	RUH	315 176	15.4%
6	Sharjah, United Arab Emirates	SHJ	314 424	-9.1%
7	Cairo, Egypt	CAI	278 877	-0.6%
8	Bahrain	BAH	262 292	-6.1%
9	Kuwait	KWI	184 784	-5.6%
10	Muscat, Oman	MCT	113 269	14.7%

Middle East & Egypt: Top 10 Airports by Movements

Rank	City, Country	Airport Code	Total Movements	% Change
1	Dubai, United Arab Emirates	DXB	344 245	5.5%
2	Jeddah, Saudi Arabia *	JED	208 209	27.9%
3	Doha, Qatar	DOH	190 962	9.5%
4	Riyadh, Saudi Arabia *	RUH	150 383	10.8%
5	Cairo, Egypt	CAI	143 300	10.1%
6	Abu Dhabi, United Arab Emirates	AUH	121 638	6.0%
7	Tehran, Iran	THR	111 120	2.8%
8	Bahrain	BAH	105 931	2.4%
9	Kuwait	KWI	85 198	0.1%
10	Al Ain, United Arab Emirates	AAN	78 562	55.5%

Source : ACI, except for Kingdom's airports.